



LOCATION - LIFESTYLE - VIEWS

\$1,700,000-\$1,800,000

4 3 2 | House

Perfectly positioned approx 150 metres from the white sands of Jervis Bay, this beach house delivers a coastal lifestyle. Wake to the sound of rolling waves, breathe in the salt air and enjoy sparkling bay views — a constant reminder of those amazing beach days in summer.

Showcasing four bedrooms, three bathrooms and multiple living zones, this home offers the space and versatility to suit families, downsizers, holiday makers or investors alike.

- Master bedroom has ensuite, huge walk-in robe & Bay views.
- Bed two with ensuite, living space and rear garden access.
- Bedroom three offers spectacular views of Jervis Bay.
- Open-plan living & dining flows seamlessly to the sun-drenched front deck.
- Modern kitchen is light & bright with amazing northern outlook.
- Equipped with compact elevator/lift, ideal for retirees or anyone seeking ease of access.
- Sun-drenched north facing deck, perfect for your morning cuppa or sunset wine.
- Expansive rear al-fresco is all weather & semi-enclosed with access to the lift.
- Fenced backyard, offering potential for a beach flat or 2nd dwelling (STCA).
- 664m2 block, perfect for a duplex or landbank for the future (STCA).

With a location offering a superior level of lifestyle and convenience, positioned within walking distance to Vincentia's shopping precinct & close to Huskisson's cafe, dining scene, this property will be highly sought after.

...

Upcoming Inspections

Inspect by appointment, contact agent.

Jervis Bay Properties - Huskisson

Shop 2, 13 Hawke Street, HUSKISSON, NSW 2540



Scott Morton
0405227987



Ashton Haddy-Morton
0408162849

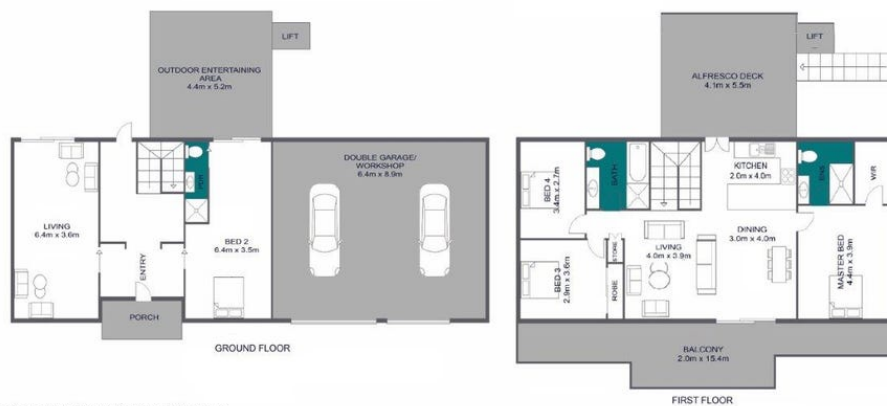

All attempts have been made to ensure the accuracy of this floor plan.
All measurements of doors, windows, opening direction, room measurements are approximate
and no responsibility is taken for any error, omission or misstatement this plan is for display purposes only and not to scale.
The total floor area is not a guarantee. Should be used as an approximation and not be used on the basis of valuation.

9 Caroline Street, Vincentia